



## ABOUT PROJECT

The Pioneer is a multifamily development located on the former Harley Davidson dealership site on Revere Beach Parkway. The proposed 6-story building places an emphasis on industrial materials and celebrates the historic architectural form. The upper-level serpentine form brings a prominence to the street level and is juxtaposed by the heights of the courtyards and townhomes to provide an undulating character to the massing.

The courtyards and roof terrace are designed to provide an array activities and amenities to the resident in a public or semi-private setting. Lounging cabanas and hammocks, kitchens and bars, outdoor games, fire pits and herb garden spaces distribute themselves around a centrally located lawn and pool to create a comfortable space. The streetscape is activated with a new cafe and outdoor seating opportunities, street trees, and updated lighting to encourage a safe environment.

## DETAILS

**Location**  
Everett, Massachusetts

**Client**  
Post Road Residential

**Architect**  
Bargmann Hendrie +  
Archetype

**Project Facts**  
Project Area: 3 acres  
Streetscape: 22,000 ft<sup>2</sup>  
Courtyard: 24,000 ft<sup>2</sup>  
Building: 378,000 ft<sup>2</sup>  
Units: 284

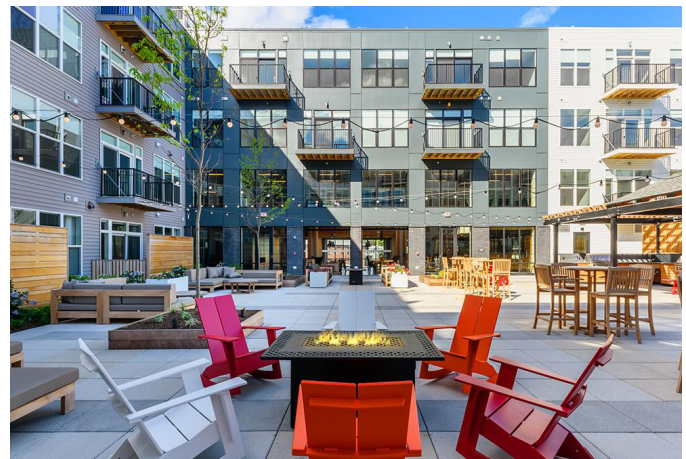

## Brown + Sardina

Landscape Architecture + Planning + Urban Design  
24 Roland Street, 3rd Floor  
Boston, MA 02129  
617-482-4703  
[www.brownsardina.com](http://www.brownsardina.com)